



The electric cylinder is an automation product that converts the rotary motion into linear motion.

Various types of motors (such as Servo motor, Stepper motor, Brush motor, Brushless motor) as used to drive different types of screw (or nut) to rotate and pass between components.

Best benefit the features of servo control systems which include precise speed control, precise torque control will be converted into precise force control, precise speed control and precise position control of electric cylinder, it's revolutionary product for high-precision linear motion.

The advantage of Servo Cylinder

- A pair of high strength bearing built in to ensure same push and pull force
- Excellent lubrication, ambient environment temperature -10 ~ 80 deg
- High quality seal on both end of cylinder for better performance
- Built in stroke limit sensor.

Applications

Any application which requires linear motion and precision control to replace Hydraulic cylinder & pneumatic cylinders.

Industrial Application

SPM, Packaging machine, Welding Machine, Pressing systems

Automobile

Press Machine & Testing system, Robotics, Welding

Military

Simulator

Medical Equipment's

Surgery & Robotic Arm

Model Number

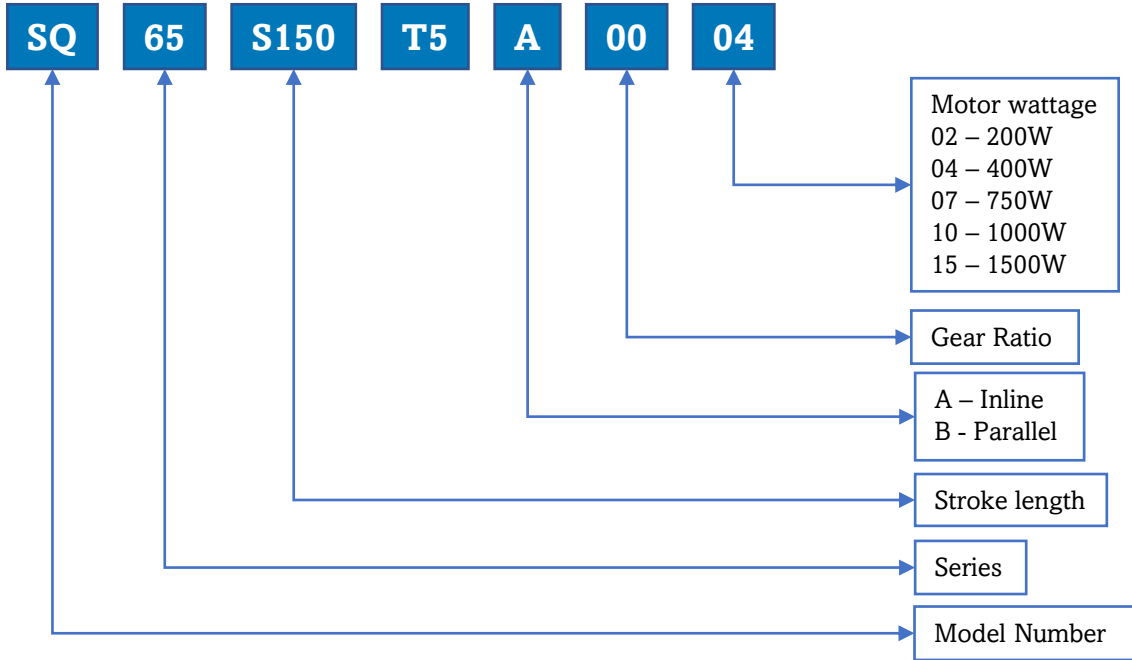

Mounting Parts

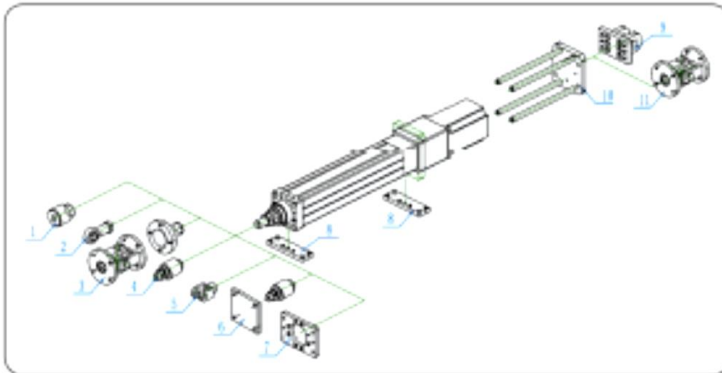

1. female-threaded rod top
2. spherical joint bearing
3. front universal joint
4. floating terminal
5. rod clevis
6. floating terminal with flange
7. front flange
8. side tapped mounting
9. rear clevis
10. rear flange
11. rear universal joint

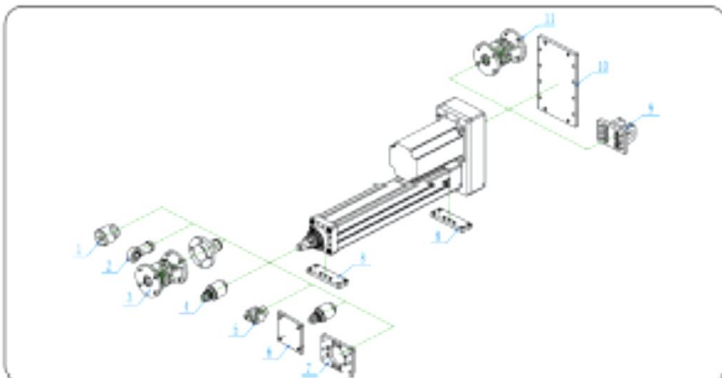

1. female-threaded rod top
2. spherical joint bearing
3. front universal joint
4. floating terminal
5. rod clevis
6. floating terminal with flange
7. front flange
8. side tapped mounting
9. rear clevis
10. rear flange
11. rear universal joint



Technical specifications

Specifications	Description
Model Number	SQ-44
Screw Lead (mm)	4
Max motor power (W)	400
Max rated force (N)	500
Max rated speed (mm/sec)	100
Max Ballscrew diameter (mm)	12
Max stroke (mm)	500
Accuracy (mm)	0.1
Repeatability (mm)	0.01

Mechanical dimensions

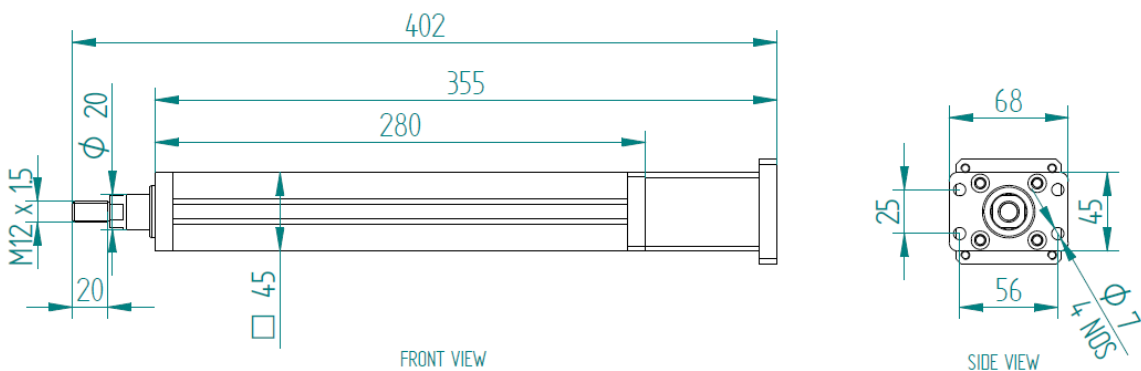



Technical specifications

Specifications	Description	
Model Number	SQ-65	
Screw Lead (mm)	5	10
Max motor power (W)	750	750
Max rated force (N)	2500	2500
Max rated speed (mm/sec)	250	500
Max Ballscrew diameter (mm)	16	16
Max stroke (mm)	500	500
Accuracy (mm)	0.1	0.1
Repeatability (mm)	0.01	0.01

Mechanical dimensions

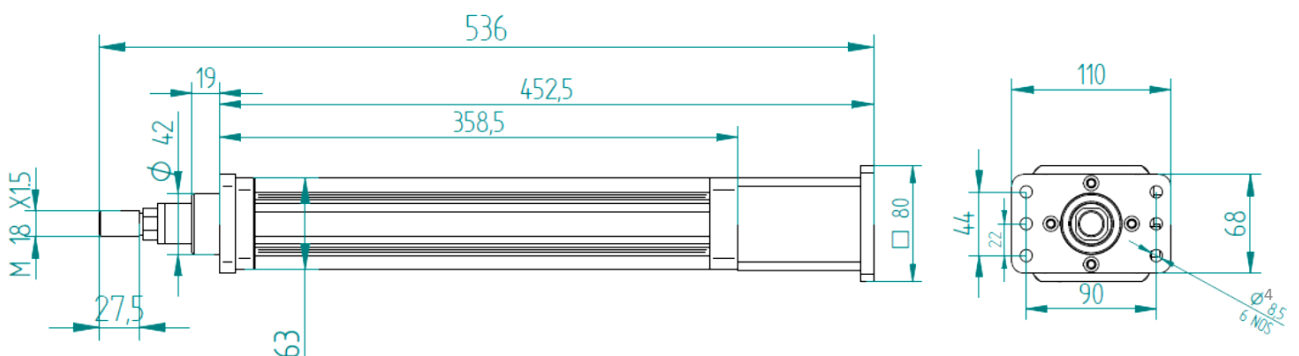



Technical specifications

Specifications	Description	
Model Number	SQ-75	
Screw Lead (mm)	5	10
Max motor power (W)	750	750
Max rated force (N)	8000	2500
Max rated speed (mm/sec)	250	500
Max Ballscrew diameter (mm)	25	20
Max stroke (mm)	800	800
Accuracy (mm)	0.1	0.1
Repeatability (mm)	0.01	0.01

Mechanical dimensions

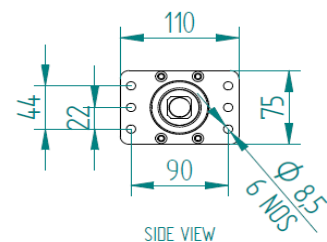
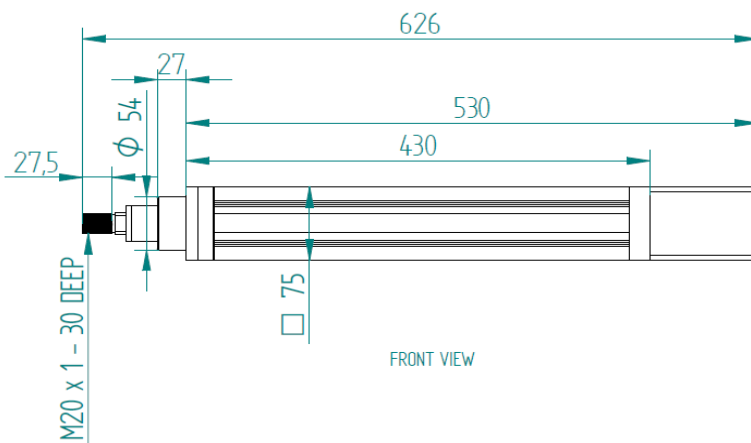

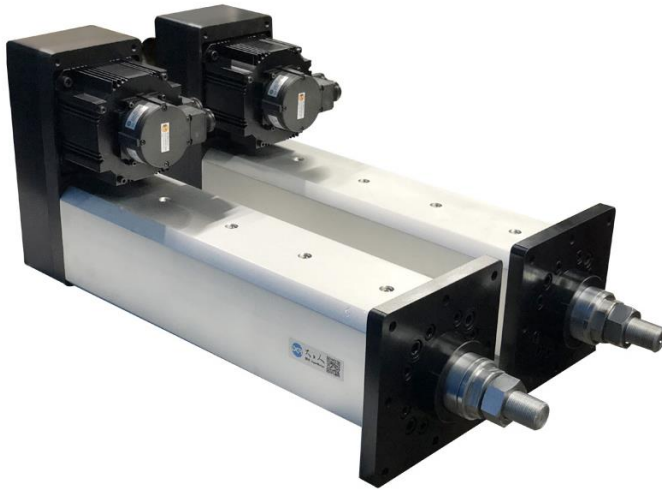

Technical specifications

Specifications	Description	
Model Number	SQ-95	
Screw Lead (mm)	5	10
Max motor power (W)	1500	2000
Max rated force (N)	15000	10000
Max rated speed (mm/sec)	80	100
Max Ballscrew diameter (mm)	40	40
Max stroke (mm)	800	800
Accuracy (mm)	0.1	0.1
Repeatability (mm)	0.01	0.01

Mechanical dimensions

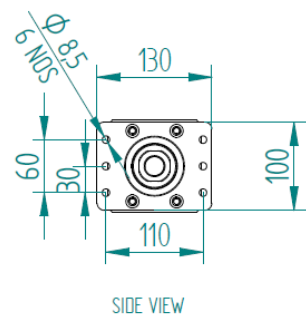
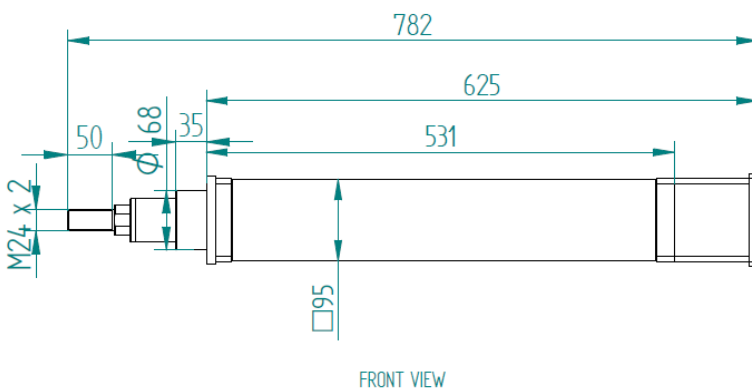

Applications

Servo Press



Servo Press Software

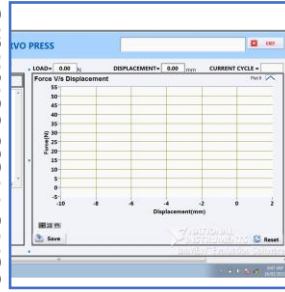

Servo Press



Durability Testing



Heat Stacking SPM



Bending Application



Servo Press



Durability Application



Testing Application



Bearing Pressing Automation



Contact:

Square Automation

81/2, Dangat Industrial estate, NDA Road, Shivane, Pune – 411023

Mob: 965733 2859 / 94225 48391

Email: square.automation@gmail.com Website: www.square-automation.com